

### ■ Q03 Straight Socket

- Connector series: Q03.0XX.01
- Contact: Female
- Locking type: Self-Locking
- Orientation type: Straight
- Part No.: Q03.0XX.01
- Mated with: Q01.0XX.02/Q02.0XX.02

Note: "X" refers to part number definition on page 121

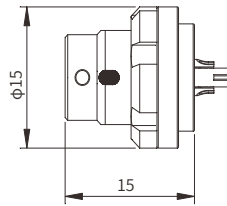

### ■ General Information

Ambient temperature:	-20°C ~ + 80°C
Endurance:	>10000 cycles
Insulator:	PEEK
Connector contacts:	Brass with gold plated
Out shell:	Brass with Black nickel plated

Insulator resistance:	≥100MΩ
IP rating:	IP 68
Shielding efficiency:	at 10MHz>75dB/at 1GHz>40dB
Salt spray corrosion test:	>96h

### ■ Q04 Straight Plug

- Connector series: Q04.0XX.02
- Contact: Male
- Locking type: Self-Locking
- Orientation type: Straight
- Part No.: Q04.0XX.02
- Mated with: Q03.0XX.01

Note: "X" refers to part number definition on page 121

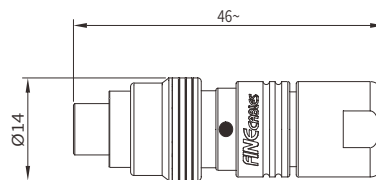

### ■ General Information

Ambient temperature:	-20°C ~ + 80°C
Endurance:	>10000 cycles
Insulator:	PEEK
Connector contacts:	Brass with gold plated
Out shell:	Brass with Black nickel plated

Insulator resistance:	≥100MΩ
IP rating:	IP 68
Shielding efficiency:	at 10MHz>75dB/at 1GHz>40dB
Salt spray corrosion test:	>96h